



SCB-HT Series Slew Rings



SCB-HT Series



Introduction

SCB-HT bearings have the same configuration as the SCB-HS bearing. Produced with a larger cross section ring and larger diameter rolling elements. OD size range = 36"-66"
Increased capacity over the SCB-HS bearing.

Construction

- Deep groove gothic arch
- 4 point contact
- Sealed
- Ring Configuration:
 - * Non geared
 - * External gear
 - * Internal gear
- Geared rings have tapped holes
- Non geared rings have thru holes
- Gear detail:
 - * Involute Stub
 - * 20 deg
 - * AGMA class 8
 - * .005"-.025" allowable backlash
- Grease fittings for lubrication

Applications:

- Rotary table
- Lifts
- Material handling
- Derricks
- Rotators
- Stretch wrap equipment
- Crane

Customer First Service Foremost

No Gear

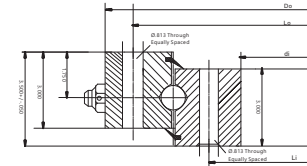

SOCARE™ P/N	KAYDON P/N	OUTLINE DIMENSIONS AND WEIGHT						Gear Data				Moment Rating C _{rm} (ft.-lbs)	
		Do (in)	di (in)	G Approx. (lbs)	OUTER RING Lo (in)	no	INNER RING Li (in)	ni	INV.STUB,α=20° D2 (in) Pd (in) Z2 Fz (lbs)				
SCB-HT914	HT10-30P1Z	36.000	24.000	447	33.250	24	26.750	30					340,000
SCB-HT1066	HT10-36P1Z	42.000	30.000	521	39.250	28	32.750	32					395,700
SCB-HT1219	HT10-42P1Z	48.000	36.000	628	45.250	32	38.750	36					457,000
SCB-HT1371	HT10-48P1Z	54.000	42.000	719	51.250	36	44.750	40					517,900
SCB-HT1524	HT10-54P1Z	60.000	48.000	809	57.250	40	50.750	44					578,400
SCB-HT1676	HT10-60P1Z	66.000	54.000	865	63.250	44	56.750	48					638,800

Customer First Service Foremost



Internal Gear

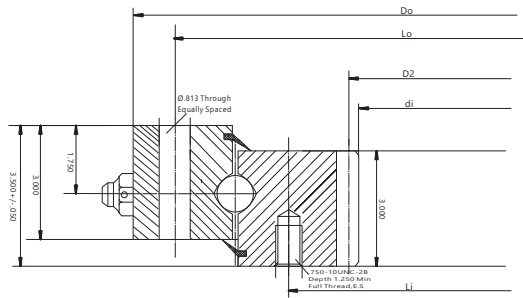

External Gear

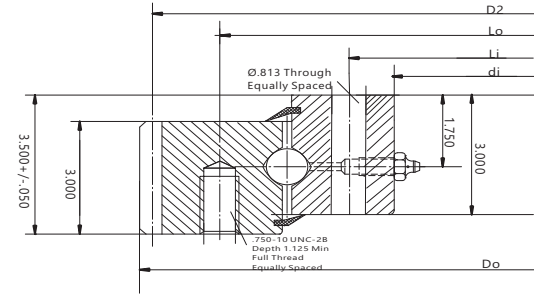

SOCARE™ P/N	KAYDON P/N	OUTLINE DIMENSIONS AND WEIGHT			Gear Data INV.STUB, α=20°							Moment Rating Crm (ft-lbs)	
		Do (in)	di (in)	G Approx. (lbs)	OUTER RING Lo (in)	no	INNER RING Li (in)	ni	D2 (in)	Pd (in)	Z2		Fz (lbs)
SCB-HTN914	HT10-30N1Z	36.000	24.160	411	33.250	24	27.250	30	24.800	2.5	62	21,783	340,000
SCB-HTN1066	HT10-36N1Z	42.000	30.160	517	39.250	28	33.250	32	30.800	2.5	77	21,195	395,700
SCB-HTN1219	HT10-42N1Z	48.000	36.160	580	45.250	32	39.250	36	36.800	2.5	92	20,819	457,000
SCB-HTN1371	HT10-48N1Z	54.000	42.160	689	51.250	36	45.250	40	42.800	2.5	107	20,548	517,900
SCB-HTN1524	HT10-54N1Z	60.000	48.160	775	57.250	40	51.250	44	48.800	2.5	122	20,344	578,400
SCB-HTN1676	HT10-60N1Z	66.000	54.160	842	63.250	44	57.250	48	54.800	2.5	137	20,185	638,800

SOCARE™ P/N	KAYDON P/N	OUTLINE DIMENSIONS AND WEIGHT			Gear Data INV.STUB, α=20°							Moment Rating Crm (ft-lbs)	
		Do (in)	di (in)	G Approx. (lbs)	OUTER RING Lo (in)	no	INNER RING Li (in)	ni	D2 (in)	Pd (in)	Z2		Fz (lbs)
SCB-HTE910	HT10-30E1Z	35.840	24.000	398	32.750	24	26.750	30	35.200	2.5	88	18,393	340,000
SCB-HTE1062	HT10-36E1Z	41.840	30.000	481	38.750	28	32.750	32	41.200	2.5	103	18,608	395,700
SCB-HTE1215	HT10-42E1Z	47.840	36.000	562	44.750	32	38.750	36	47.200	2.5	118	18,772	457,000
SCB-HTE1367	HT10-48E1Z	53.840	42.000	660	50.750	36	44.750	40	53.200	2.5	133	18,901	517,900
SCB-HTE1519	HT10-54E1Z	59.840	48.000	742	56.750	40	50.750	44	59.200	2.5	148	19,005	578,400
SCB-HTE1672	HT10-60E1Z	65.840	54.000	800	62.750	44	56.750	48	65.200	2.5	163	19,090	638,800



Hydraulic Aerial Cage



Industrial turntable



Lift truck rotators



Digger derricks

Customer First Service Foremost

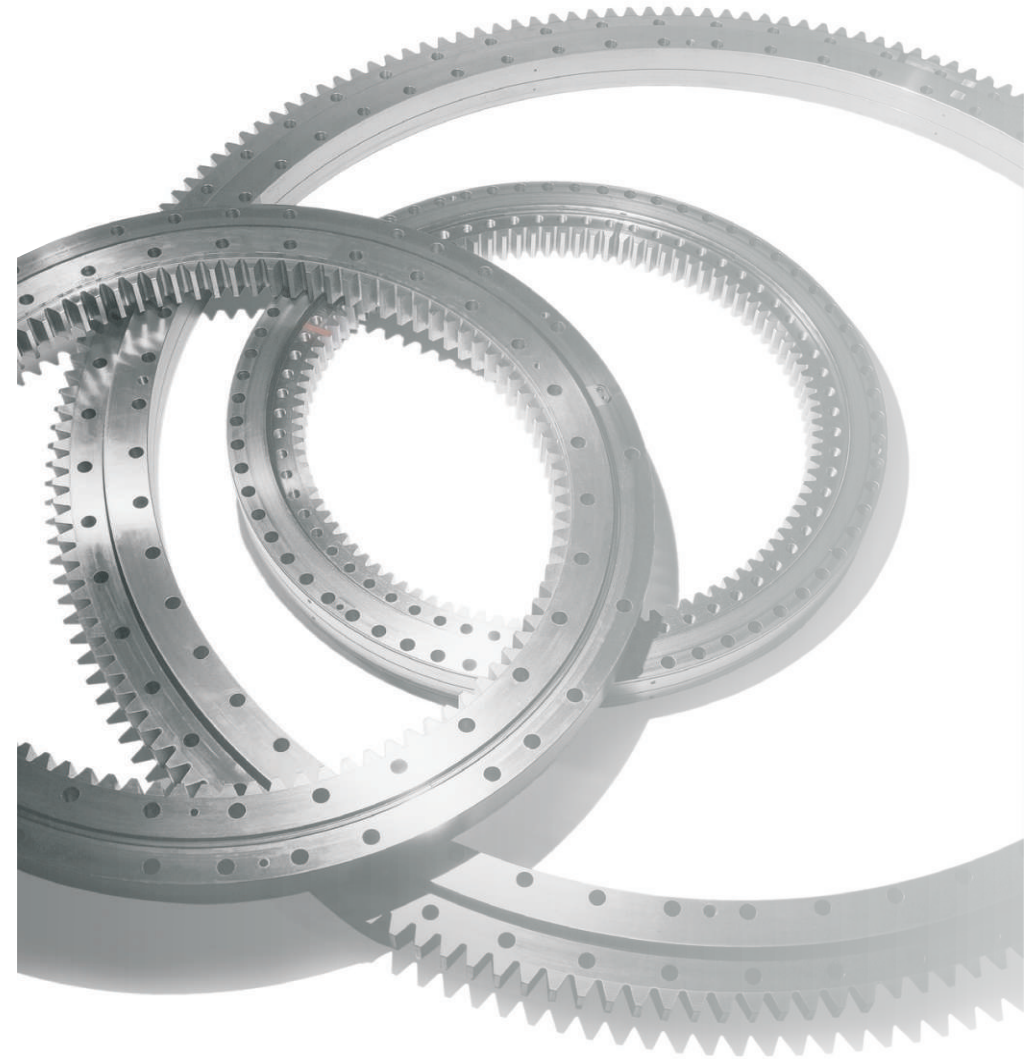

Customer First Service Foremost